Report To:	Environment and Regeneration Committee	Date:	16 January 2020
Report By:	Corporate Director Environment, Regeneration and Resources	Report No:	E&R/20/01/02/SJ/AW
Contact Officer:	Alan Williamson	Contact No:	01475 712491
Subject:	Road Naming within New Development at Kilmacolm Road, Greenock		

1.0 PURPOSE

- 1.1 The purpose of this report is to seek Committee approval to name new roads being created within the Cloch Housing Association development at Kilmacolm Road, Greenock.

2.0 SUMMARY

- 2.1 New road names are required for the internal roads of the new residential development by Cloch Housing Association at Kilmacolm Road, Greenock.

3.0 RECOMMENDATIONS

- 3.1 It is recommended that the Committee approves King's Glen Place, Godman Place and Woodhead Road as the names of the new roads within the development at Kilmacolm Road, Greenock, as set out in Appendix 1.

Stuart W. Jamieson
Head of Regeneration and Planning

4.0 BACKGROUND

4.1 Section 97 of the Civic Government (Scotland) Act 1982 gives a local authority power to name roads within its area.

5.0 NEW DEVELOPMENT AT KILMACOLM ROAD, GREENOCK

5.1 Cloch Housing Association is developing 57 new flats and houses on the site of the former Kings Glen Primary at Kilmacolm Road, Greenock. The development will have three internal roads that require to be named. For consultation with Ward 3 Councillors, it was suggested that two of the roads be named after the adjacent King's Glen and former Woodhead Quarry. These were not objected to and an additional suggestion of naming one of the roads Godman (after the former MP and MSP for the area) was received during the Councillor consultation.

5.2 Cloch Housing Association suggested the following which were received during its own consultation exercise:

- Kings Glen Avenue/Court/Road/Place
- Anderson Place/Road (after a former headteacher of King's Glen Primary School)
- Lind Way (after a former music teacher at King's Glen Primary School)
- Cloch Avenue/View
- Kilmacolm Avenue
- Brown Road/Avenue/Court (after the first permanent Director of Cloch HA)
- Cassells Close (after a former Cloch colleague)

5.3 It is recommended that the new roads within this development are named: King's Glen Place, Godman Place and Woodhead Road.

6.0 IMPLICATIONS

Finance

6.1 There are no financial implications associated with this report.

Financial Implications:

One off Costs

Cost Centre	Budget Heading	Budget Years	Proposed Spend this Report	Virement From	Other Comments
n/a	n/a	n/a	n/a	n/a	n/a

Annually Recurring Costs/(Savings)

Cost Centre	Budget Heading	With Effect from	Annual Net Impact	Virement From (If Applicable)	Other Comments
n/a	n/a	n/a	n/a	n/a	n/a

Legal

6.2 There are no legal implications associated with this report.

Human Resources

6.3 There are no personnel implications associated with this report.

Equalities

6.4 There are no equalities issues associated with this report.

Repopulation

6.5 There are no repopulation implications associated with this report.

7.0 CONSULTATIONS

7.1 Ward Councillors and the Council's Legal and Property Services were consulted during the preparation of this report.

8.0 LIST OF BACKGROUND PAPERS

8.1 None

Appendix 1: New residential development Kilmacolm Road, Greenock

APPENDIX 1

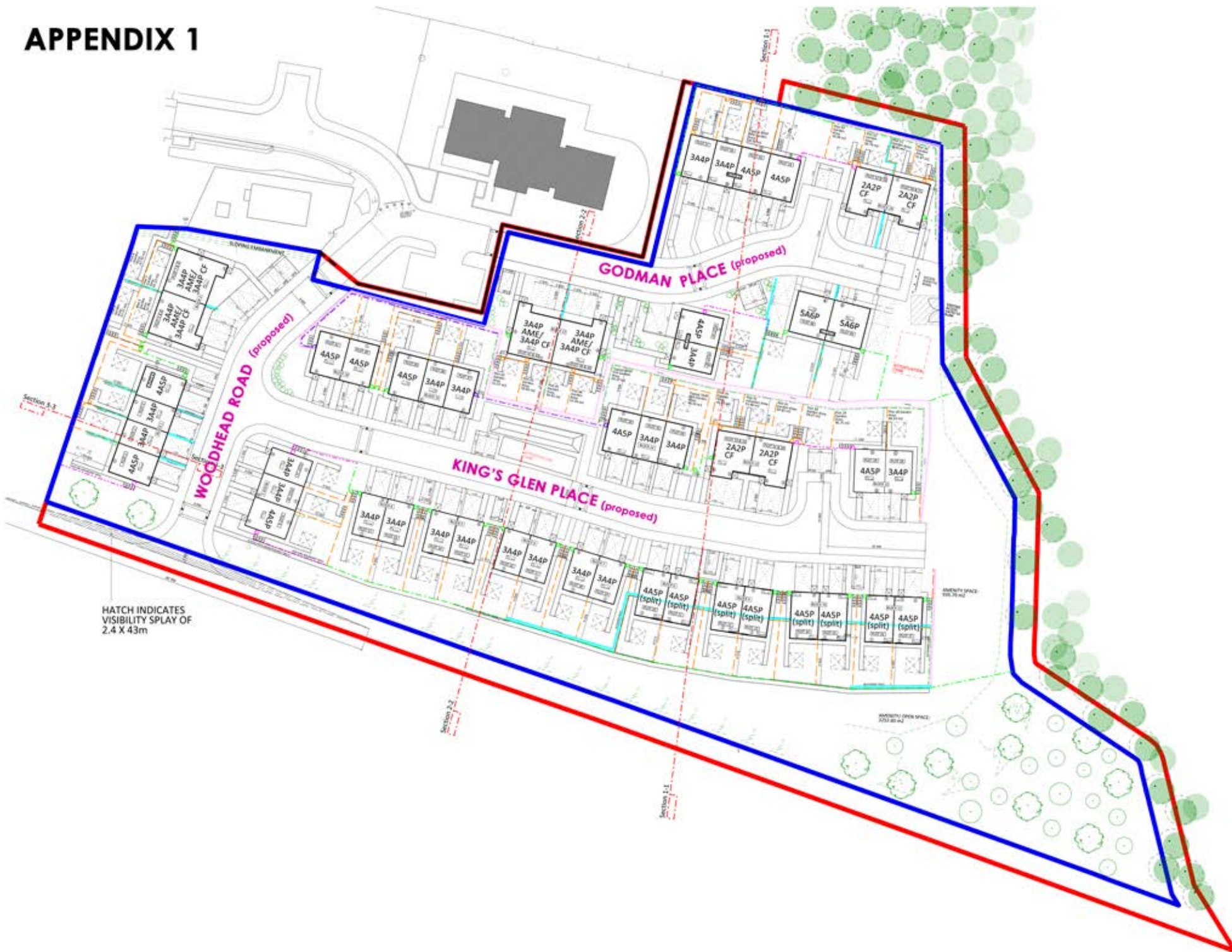

APPLICABLE REGULATIONS
 CEAM 2015 & HANAN ACT 1974 (and all amendments) - Applies at all times.
 Working at Height Regs 2005 - Applies at all times.
 Workplace (Health, Safety and Welfare) Regs 1992 - Applies at all times.
 Control of Asbestos Regs 2012 - Applies at all times.

Notes

Rev	Description	Date	Issued

0 10 20 30 40 50 60 70 80 90 100
 METRES

51 St Vincent Crescent
 Glasgow
 G3 7NG

T: 0141 221 8838
 E: mast@mastarchitects.co.uk
 W: mastarchitects.co.uk

MAST ARCHITECTS

MASTARCH Ltd trading as MAST Architects registered as Scotland, Company Number SC447112, whose registered office is at 51 St Vincent Crescent, Glasgow, G3 7NG

DO NOT SCALE FROM DRAWINGS
 All dimensions to be checked on site by the Contractor and any discrepancies to be notified to the Architect prior to works being commenced. Use figured dimensions only.

© All Rights Reserved. Copyright in all documents and drawings prepared by MAST Architects and in any work executed from those documents and drawings shall remain the property of MAST Architects.

Client
 CCG (SCOTLAND) LTD

Scale	Sheet Size	Job No.
1:500	A2	2817-1

Originator	Checked	Date
PD	AP	OCT 19

Project
 PROPOSED HOUSING
 KILMACOLM ROAD,
 GREENOCK

Drawing Title
 SITE PLAN - STREET NAMING
 APPLICATION

Drawing No.	Rev
L(20)015	-